

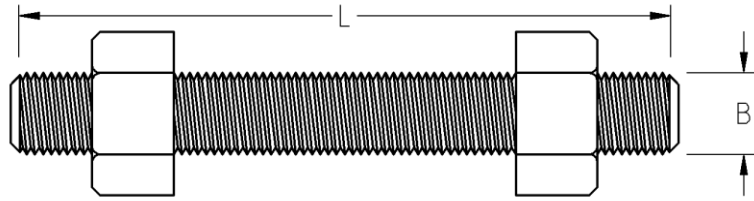

Flange Bolting
CLASS 150 - 600
Inches



Size	150 Class				300 Class					600 Class				
	Bolt Dia (B)	Qty	RF (L*)	RTJ (L*)	Bolt Dia (B)	Qty	RF (L*)	RTJ (L*)	Orifice RF (L**)	Bolt Dia (B)	Qty	RF (L*)	RTJ (L*)	Orifice RF (L**)
1/2	1/2	4	2.25		1/2	4	2.50	3.00		1/2	4	3.00	3.00	
3/4	1/2	4	2.50		5/8	4	3.00	3.50		5/8	4	3.50	3.50	
1	1/2	4	2.50	3.00	5/8	4	3.00	3.50	5.00	5/8	4	3.50	3.50	5.00
1 1/4	1/2	4	2.75	3.25	5/8	4	3.25	3.75		5/8	4	3.75	3.75	
1 1/2	1/2	4	2.75	3.25	3/4	4	3.50	4.00	5.25	3/4	4	4.25	4.25	5.25
2	5/8	4	3.25	3.75	5/8	8	3.50	4.00	5.25	5/8	8	4.25	4.25	5.25
2 1/2	5/8	4	3.50	4.00	3/4	8	4.00	4.50	5.25	3/4	8	4.75	4.75	5.25
3	5/8	4	3.50	4.00	3/4	8	4.25	4.75	5.25	3/4	8	5.00	5.00	5.25
3 1/2	5/8	8	3.50	4.00	3/4	8	4.25	5.00		7/8	8	5.50	5.50	
4	5/8	8	3.50	4.00	3/4	8	4.50	5.00	5.25	7/8	8	5.75	5.75	6.00
5	3/4	8	3.75	4.25	3/4	8	4.75	5.25		1	8	6.50	6.50	
6	3/4	8	4.00	4.50	3/4	12	4.75	5.50	5.25	1	12	6.75	6.75	7.00
8	3/4	8	4.25	4.75	7/8	12	5.50	6.00	5.75	1 1/8	12	7.50	7.75	7.75
10	7/8	12	4.50	5.00	1	16	6.25	6.75	6.50	1 1/4	16	8.50	8.50	8.75
12	7/8	12	4.75	5.25	1 1/8	16	6.75	7.25	7.00	1 1/4	20	8.75	8.75	9.00
14	1	12	5.25	5.75	1 1/8	20	7.00	7.50	7.25	1 3/8	20	9.25	9.25	9.50
16	1	16	5.25	5.75	1 1/4	20	7.50	8.00	7.75	1 1/2	20	10.00	10.00	10.25
18	1 1/8	16	5.75	6.25	1 1/4	24	7.75	8.25	8.00	1 5/8	20	10.75	10.75	11.00
20	1 1/8	20	6.25	6.75	1 1/4	24	8.00	8.75	8.50	1 5/8	24	11.25	11.50	11.75
24	1 1/4	20	6.75	7.25	1 1/2	24	9.00	10.00	9.50	1 7/8	24	13.00	13.25	13.25

** Dimensions conform to ASME B16.5 and are considered a minimum.*

**The length of the stud bolt does not include the height of the chamfer.*

*** Dimensions conform to ASME B16.36 and are considered a minimum.*



Flange Bolting
CLASS 900 - 2500
Inches

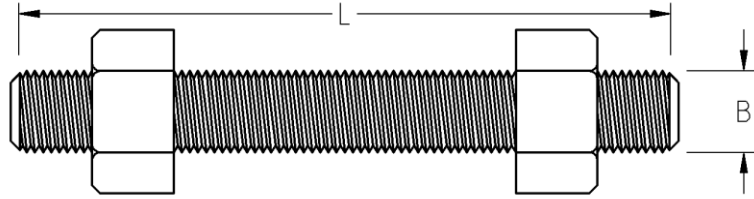

Size	900 Class					1500 Class					2500 Class				
	Bolt Dia (B)	Qty	RF (L*)	RTJ (L*)	Orifice RF (L**)	Bolt Dia (B)	Qty	RF (L*)	RTJ (L*)	Orifice RF (L**)	Bolt Dia (B)	Qty	RF (L*)	RTJ (L*)	Orifice RF (L**)
1/2	Use 1500 Flange					3/4	4	4.25	4.25		3/4	4	4.75	4.75	
3/4						3/4	4	4.50	4.50		3/4	4	5.00	5.00	
1						7/8	4	5.00	5.00	6.00	7/8	4	5.50	5.50	6.00
1 1/4						7/8	4	5.00	5.00		1	4	6.00	6.00	
1 1/2						1	4	5.50	5.50	6.25	1 1/8	4	6.75	6.75	7.00
2						7/8	8	5.75	5.75	6.25	1	8	7.00	7.00	7.25
2 1/2						1	8	6.25	6.25	6.50	1 1/8	8	7.75	8.00	8.00
3						7/8	8	5.75	5.75	6.00	1 1/8	8	7.00	7.00	7.25
4	1 1/8	8	6.75	6.75	7.00	1 1/4	8	7.75	7.75	8.00	1 1/2	8	10.00	10.25	10.25
5	1 1/4	8	7.50	7.50		1 1/2	8	9.75	9.75		1 3/4	8	11.75	12.25	
6	1 1/8	12	7.50	7.75	7.75	1 3/8	12	10.25	10.50	10.50	2	8	13.50	14.00	13.75
8	1 3/8	12	8.75	8.75	9.00	1 5/8	12	11.50	11.75	11.75	2	12	15.00	15.50	15.25
10	1 3/8	16	9.25	9.25	9.50	1 7/8	12	13.25	13.50	13.50	2 1/2	12	19.25	20.00	19.25
12	1 3/8	20	10.00	10.00	10.25	2	16	14.75	15.25	15.00	2 3/4	12	21.25	22.00	21.25
14	1 1/2	20	10.75	11.00	11.00	2 1/4	16	16.00	16.75	16.25					
16	1 5/8	20	11.25	11.50	11.5	2 1/2	16	17.50	18.50	17.75					
18	1 7/8	20	12.75	13.25	13.00	2 3/4	16	19.50	20.75	19.75					
20	2	20	13.75	14.25	14.00	3	16	21.25	22.25	21.50					
24	2 1/2	20	17.25	18.00	17.50	3 1/2	16	24.25	25.50	24.50					

* Dimensions conform to ASME B16.5 and are considered a minimum.

*The length of the stud bolt does not include the height of the chamfer.

** Dimensions conform to ASME B16.36 and are considered a minimum.