

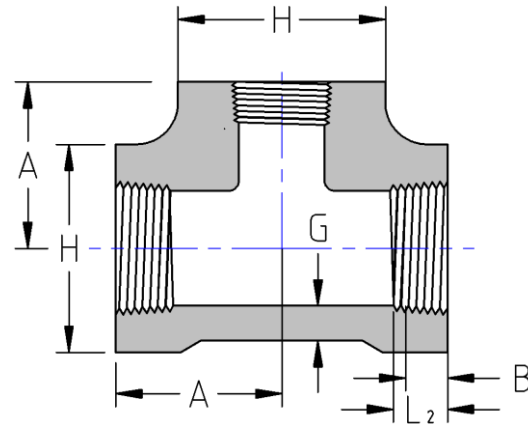

Threaded Reducing Tee  
**3000# Forged Steel**  
Inches / Pounds



Size	A	H	G (min)	Approximate Weight (in Pounds)
3/4 x 1/2	1.50	1.81	0.170	1.90
1 x 1/2	1.75	2.19	0.196	3.15
1 x 3/4	1.75	2.19	0.196	3.10
1 1/4 x 1/2	2.00	2.44	0.208	3.70
1 1/4 x 3/4	2.00	2.44	0.208	3.65
1 1/4 x 1	2.00	2.44	0.208	3.60
1 1/2 x 1/2	2.38	2.97	0.219	7.10
1 1/2 x 3/4	2.38	2.97	0.219	7.00
1 1/2 x 1	2.38	2.97	0.219	6.90
1 1/2 x 1 1/4	2.38	2.97	0.219	6.80
2 x 1/2	2.50	3.31	0.281	7.70
2 x 3/4	2.50	3.31	0.281	7.60
2 x 1	2.50	3.31	0.281	7.50
2 x 1 1/4	2.50	3.31	0.281	7.40
2 x 1 1/2	2.50	3.31	0.281	7.30

**\*ASME B16.11**

**\*\*Dimension B is minimum length of perfect thread. The length of useful thread (B plus threads with fully formed roots and flat crests) shall not be less than L<sub>2</sub> (effective length of external thread) required by ASME B1.20.1**