

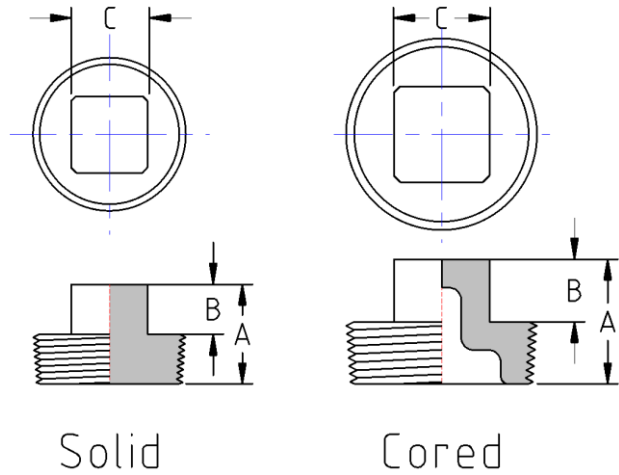

Square Head Plug, Cored
150# Malleable Iron
Inches / Pounds



Nominal Pipe Size	Overall Length (A)	Height of Square Min. (B)	Nominal Width Across Flats (C)	Solid or Cored	Approx. Weight (in Pounds)
1/8	0.65	0.24	0.28	Solid	0.02
1/4	0.75	0.28	0.37	Solid	0.03
3/8	0.85	0.31	0.43	Solid	0.05
1/2	1.00	0.38	0.56	Cored	0.09
3/4	1.15	0.44	0.63	Cored	0.14
1	1.30	0.50	0.82	Cored	0.22
1 1/4	1.40	0.56	0.94	Cored	0.37
1 1/2	1.50	0.62	1.13	Cored	0.54
2	1.60	0.68	1.31	Cored	0.82
2 1/2	1.85	0.74	1.50	Cored	1.30
3	1.95	0.80	1.69	Cored	1.70
3 1/2	2.10	1.00	2.28	Cored	2.50
4	2.30	1.00	2.50	Cored	2.62
5	2.50	1.25	3.03	Cored	5.26
6	2.80	0.24	0.28	Cored	6.58

***Malleable Castings conform to ASTM A197**

***Hot-Dipped Galvanized Fittings conform to ASTM A153**

***Malleable Fitting Dimensions conform to ASME B16.3**

***Malleable Bushings, Plugs and Locknuts conform to ASME B16.14**

***Malleable Unions conform to ASME B16.39**

***NPT Threads on all fittings conform to ASME B1.20.1**