

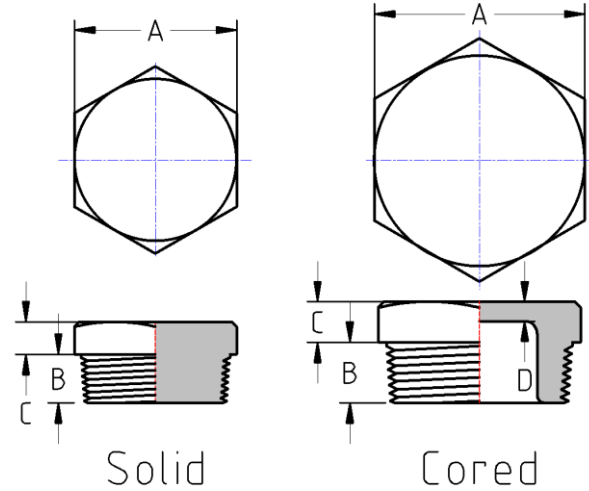

Threaded Hex Head Plug
MSS SP-114 Pattern
150# Cast Stainless Steel
Inches / Pounds



Nominal Pipe Size	Nominal Width Across Flats (A)	Thread Length Min. (B)	Height of Head (C)	Nominal Metal Thickness (D)**	Approx. Weight (in Pounds)
1/8"	0.50	0.37	0.14	Solid	0.02
1/4"	0.62	0.44	0.14	Solid	0.05
3/8"	0.68	0.48	0.16	Solid	0.06
1/2"	0.87	0.56	0.19	0.16	0.11
3/4"	1.20	0.63	0.22	0.18	0.18
1"	1.43	0.75	0.25	0.20	0.31
1-1/4"	1.76	0.80	0.28	0.22	0.50
1-1/2"	2.00	0.83	0.31	0.24	0.67
2"	2.48	0.88	0.34	0.26	1.03
2-1/2"	2.98	1.07	0.37	0.29	1.88
3"	3.86	1.13	0.40	0.31	2.41
4"	4.62	1.22	0.50	0.38	4.45

****The material composition and quality comply with ASTM A351/A351M "Standard Specification for Castings, Austenitic, for Pressure-Containing Parts"***

****NPT Threads on all fittings conform to ASME B1.20.1***

****Dimensions comply with MSS SP-114***

***** Patterns shall be designed to produce castings of metal thickness given in table. Metal thickness at no point shall be less than 90% of the nominal metal thickness value.***