



The Best Products, The Best Service...

SERVICE METAL

ONE CALL GETS IT ALL

Lap Joint Flange CLASS 600 Inches / Pounds

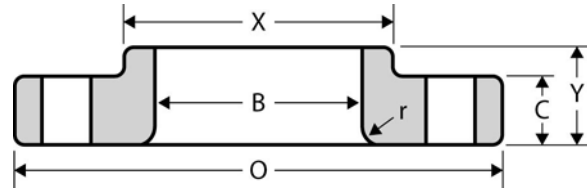

Nominal Pipe Size	Outside Diam. of Flange (O)	Thick. of Flange (C)	Diam. of Hub at Base (X)	Length thru Hub (Y)	Diam. of Bore (B)	Fillet Radius (r)	No. of Holes	Diam. of Holes	Diam. of Bolts	Diam. of Bolt Circle	Approx. Weight (in Pounds)
1/2	3.75	0.56	1.50	0.88	0.90	0.12	4	0.62	0.50	2.62	2
3/4	4.62	0.62	1.88	1.00	1.11	0.12	4	0.75	0.62	3.25	3
1	4.88	0.69	2.12	1.06	1.38	0.12	4	0.75	0.62	3.50	4
1 1/4	5.25	0.81	2.50	1.12	1.72	0.19	4	0.75	0.62	3.88	5
1 1/2	6.12	0.88	2.75	1.25	1.97	0.25	4	0.88	0.75	4.50	7
2	6.50	1.00	3.31	1.44	2.46	0.31	8	0.75	0.62	5.00	9
2 1/2	7.50	1.12	3.94	1.62	2.97	0.31	8	0.88	0.75	5.88	12
3	8.25	1.25	4.62	1.81	3.60	0.38	8	0.88	0.75	6.62	15
3 1/2	9.00	1.38	5.25	1.94	4.10	0.38	8	1.00	0.88	7.25	20
4	10.75	1.50	6.00	2.12	4.60	0.44	8	1.00	0.88	8.50	36
5	13.00	1.75	7.44	2.38	5.69	0.44	8	1.12	1.00	10.50	61
6	14.00	1.88	8.75	2.62	6.75	0.50	12	1.12	1.00	11.50	78
8	16.50	2.19	10.75	3.00	8.75	0.50	12	1.25	1.12	13.75	110
10	20.00	2.50	13.50	4.38	10.92	0.50	16	1.38	1.25	17.00	170
12	22.00	2.62	15.75	4.62	12.92	0.50	20	1.38	1.25	19.25	200
14	23.75	2.75	17.00	5.00	14.18	0.50	20	1.50	1.38	20.75	250
16	27.00	3.00	19.50	5.50	16.19	0.50	20	1.62	1.50	23.75	365
18	29.25	3.25	21.50	6.00	18.20	0.50	20	1.75	1.62	25.75	435
20	32.00	3.50	24.00	6.50	20.25	0.50	24	1.75	1.62	28.50	570
24	37.00	4.00	28.25	7.25	24.25	0.50	24	2.00	1.88	33.00	810

* Dimensions conform to ASTM A/SA-105; ANSI B16.5