

800 lb Piston Check Valve

Bolted Bonnet

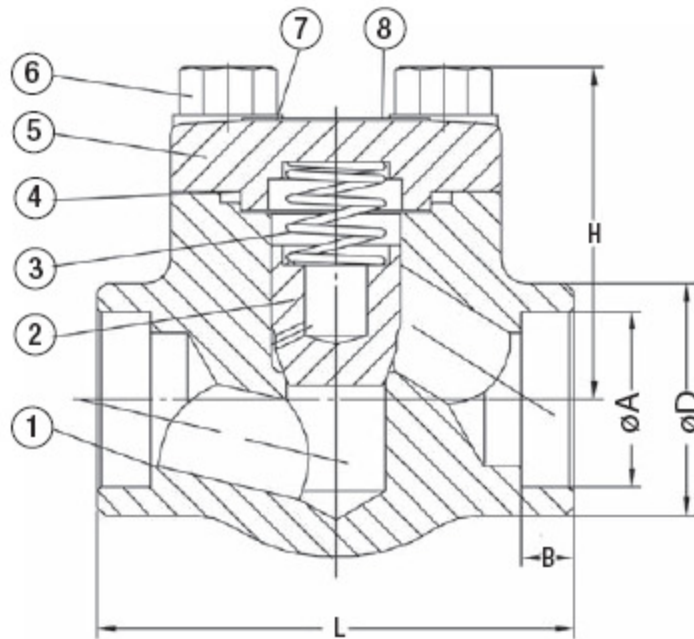

F801LT (Threaded)
F801LSW (Socket Weld)

Welded Bonnet

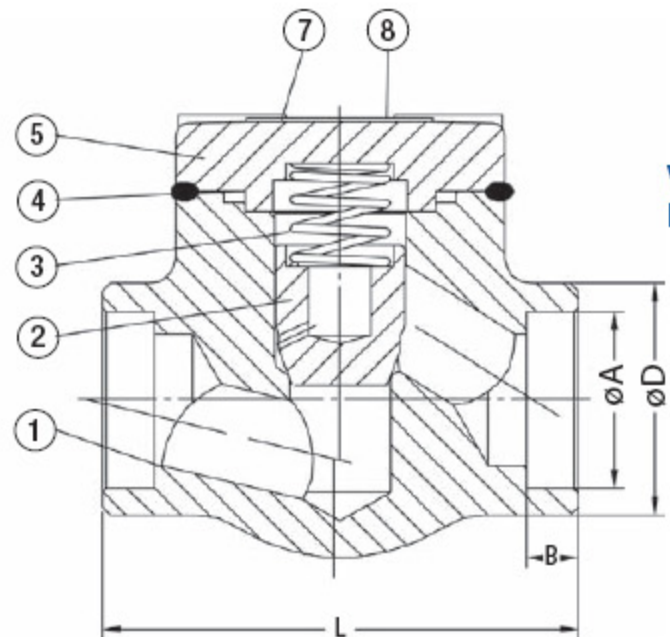

F801LT-WB (Threaded)
F801LSW-WB (Socket Weld)

Material Specifications		ASTM	ASTM	ASTM	ASTM
NO.	Part Name	Type A105	Type F22	Type F304(L)	Type F316(L)
1	Body	A105	A182 F22	A182 F304(L)	A182 F316(L)
2	Piston Disc	A276 410	A276 304	A276 304(L)	A276 316(L)
3	Spring	17-4PH	17-4PH	17-4PH	17-4PH
4	Gasket	Corrugated SS + Graphite	Corrugated SS + Graphite	SS+PTFE	SS+PTFE
5	Bonnet	A105	A182 F22	A182 F304(L)	A182 F316(L)
6	Bolt	A193 B7	A193 B16	A193 B8M	A193 B8(M)
7	Nameplate	SS	SS	SS	SS
8	Drive Screw	SS	SS	SS	SS
	Suitable Medium	W.O.G. etc.	W.O.G. etc.	HNO ₃ , CH ₃ OOH etc	HNO ₃ , CH ₃ OOH etc
	Suitable Temperature	-29°C~425°C	-29°C~550°C	-29°C~180°C	-29°C~180°C

Dimensions (in) and Weights (lb)

NPS	Conv.	3/8	1/2	3/4	1	1-1/4	1-1/2	2	
	Full		3/8	1/2	3/4	1	1-1/4	1-1/2	2
L		3.11	3.11	3.62	4.37	4.72	5.98	6.77	7.87
H		2.40	2.40	2.56	3.11	3.74	4.06	4.65	5.20
Weights	Bolted	3.09	2.65	3.31	6.84	8.60	12.35	19.62	27.56
	Welded	2.43	2.21	2.65	6.39	7.28	10.80	17.86	24.03