

The Best Products, The Best Service...

SERVICE METAL

ONE CALL GETS IT ALL



90° Elbow
150# Malleable Iron
Inches / Pounds

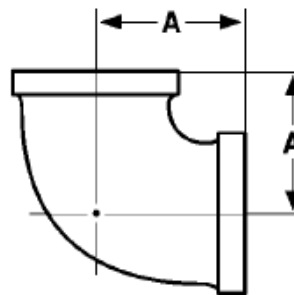

Size	A	Approximate Weight (in Pounds)
1/8	0.69	0.06
1/4	0.81	0.11
3/8	0.95	0.17
1/2	1.12	0.24
3/4	1.31	0.40
1	1.50	0.64
1 1/4	1.75	0.95
1 1/2	1.94	1.24
2	2.25	1.74
2 1/2	2.70	3.28
3	3.08	5.15
3 1/2	3.42	7.08
4	3.79	8.81
5	4.50	13.80
6	5.13	23.00
8	6.38	32.00

**Malleable Castings conform to ASTM A197*

**Hot-Dipped Galvanized Fittings conform to ASTM A153*

**Malleable Fitting Dimensions conform to ASME B16.3*

**Malleable Bushings, Plugs and Locknuts conform to ASME B16.14*

**Malleable Unions conform to ASME B16.39*

**NPT Threads on all fittings conform to ASME B1.20.1*

**Class 150 fittings are UL listed and FM approved at 300 psi*

**Class 300 fittings are UL listed*