

The Best Products, The Best Service...

# SERVICE METAL

ONE CALL GETS IT ALL



Square Head Plug  
**Forged Steel**  
Inches / Pounds

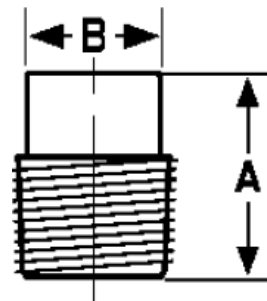

Size	A	B	Approximate Weight (in Pounds)
1/8	0.63	0.28	0.02
1/4	0.69	0.38	0.03
3/8	0.81	0.44	0.06
1/2	0.94	0.56	0.11
3/4	1.06	0.62	0.18
1	1.25	0.81	0.35
1 1/4	1.37	0.94	0.60
1 1/2	1.43	1.12	0.82
2	1.57	1.31	1.36
2 1/2	1.81	1.50	2.21
3	1.93	1.69	3.47
4	2.25	2.50	8.64

*\*ASTM SA-105, ANSI B16.11*