



The Best Products, The Best Service...

# SERVICE METAL

ONE CALL GETS IT ALL

## Short Radius 180° Return Bends

### EXTRA STRONG

Inches / Pounds

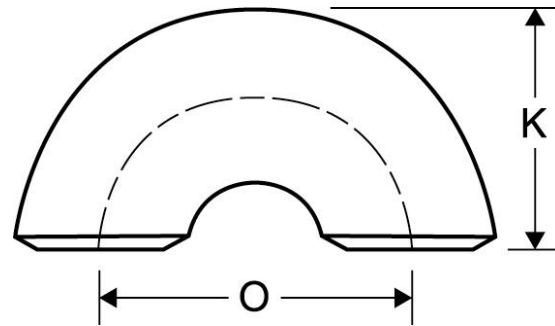

Nominal Pipe Size	Outside Diameter	Inside Diameter	Wall Thickness	Center To Center (O)	Back To Face (K)	Pipe Schedule	Approximate Weight (in Pounds)
1 1/2	1.90	1.50	.200	3.00	2.44	80	1.5
2	2.37	1.93	.218	4.00	3.19	80	2.9
2 1/2	2.87	2.32	.276	5.00	3.94	80	5.2
3	3.50	2.90	.300	6.00	4.75	80	8.2
3 1/2	4.00	3.36	.318	7.00	5.50	80	11.7
4	4.50	3.83	.337	8.00	6.25	80	16.4
5	5.56	4.81	.375	10.00	7.75	80	27.7
6	6.62	5.76	.432	12.00	9.31	80	45.7
8	8.62	7.62	.500	16.00	12.31	80	96.3
10	10.75	9.75	.500	20.00	15.38	60	143
12	12.75	11.75	.500	24.00	18.38	XS*	212
14	14.00	13.00	.500	28.00	21.00	XS*	271
16	16.00	15.00	.500	32.00	24.00	40	339
18	18.00	17.00	.500	36.00	27.00	XS*	425
20	20.00	19.00	.500	40.00	30.00	30	555
24	24.00	23.00	.500	48.00	36.00	XS*	778
30	30.00	29.00	.500	60.00	45.00	20	1,270
36	36.00	35.00	.500	72.00	54.00	XS*	1,838

*\* XS\* designates Extra Strong (extra strong wall). This size and thickness does not correspond to any pipe schedule number.*

*\* Dimensions conform to ASME B16.9 & material conforms to ASTM SA-234 Grade B.*