

The Best Products, The Best Service...

# SERVICE METAL

ONE CALL GETS IT ALL



## Hex Head Counter Sunk Plug Standard Merchant Inches / Pounds

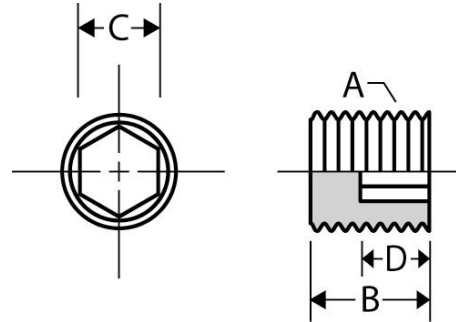

A NPTF Thread	B Body Length, Min.	C Hex Width, Nom.	D Socket Depth, Min.
1/16 - 27	.290	.1562	.12
1/8 - 27	.290	.1875	.12
1/4 - 18	.445	.2500	.19
3/8 - 18	.445	.3125	.19
1/2 - 14	.590	.3750	.25
3/4 - 14	.600	.5625	.31
1 - 11 1/2	.750	.6250	.38
1 1/4 - 11 1/2	.80	.750	.38
1 1/2 - 11 1/2	.83	1.00	.406
2 - 11 1/2	.88	1.00	.406

*\*Merchant Steel Fittings conform to the following specifications: ASTM: A865 ANSI: B16.11*