

The Best Products, The Best Service...

SERVICE METAL

ONE CALL GETS IT ALL



Hex Bushing Forged Steel Inches / Pounds

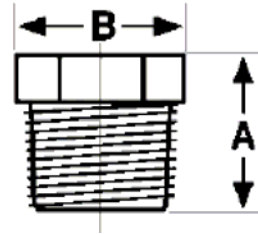

Size	A	B	Approximate Weight (in Pounds)
1/4 x 1/8	0.56	0.62	0.02
3/8 x 1/8	0.66	0.69	0.04
3/8 x 1/4	0.66	0.69	0.04
1/2 x 1/8	0.75	0.88	0.06
1/2 x 1/4	0.75	0.88	0.06
1/2 x 3/8	0.75	0.88	0.06
3/4 x 1/8	0.84	1.06	0.11
3/4 x 1/4	0.84	1.06	0.11
3/4 x 3/8	0.84	1.06	0.11
3/4 x 1/2	0.84	1.06	0.11
1 x 1/8	1.00	1.38	0.19
1 x 1/4	1.00	1.38	0.19
1 x 3/8	1.00	1.38	0.19
1 x 1/2	1.00	1.38	0.19
1 x 3/4	1.00	1.38	0.19
1 1/4 x 1/8	1.09	1.75	0.39
1 1/4 x 1/4	1.09	1.75	0.39
1 1/4 x 3/8	1.09	1.75	0.39
1 1/4 x 1/2	1.09	1.75	0.39
1 1/4 x 3/4	1.09	1.75	0.39
1 1/4 x 1	1.09	1.75	0.39
1 1/2 x 1/8	1.12	2.00	0.63
1 1/2 x 1/4	1.12	2.00	0.63
1 1/2 x 3/8	1.12	2.00	0.63
1 1/2 x 1/2	1.12	2.00	0.63
1 1/2 x 3/4	1.12	2.00	0.63
1 1/2 x 1	1.12	2.00	0.63
1 1/2 x 1 1/4	1.12	2.00	0.63
2 x 1/4	1.22	2.50	0.79
2 x 3/8	1.22	2.50	0.79
2 x 1/2	1.22	2.50	0.79

The Best Products, The Best Service...

SERVICE METAL

ONE CALL GETS IT ALL



Size	A	B	Approximate Weight (in Pounds)
2 x 3/4	1.22	2.50	0.79
2 x 1	1.22	2.50	0.79
2 x 1 1/4	1.22	2.50	0.79
2 x 1 1/2	1.22	2.50	0.79
2 1/2 x 1/2	1.44	3.00	1.19
2 1/2 x 3/4	1.44	3.00	1.19
2 1/2 x 1	1.44	3.00	1.19
2 1/2 x 1 1/4	1.44	3.00	1.19
2 1/2 x 1 1/2	1.44	3.00	1.19
2 1/2 x 2	1.44	3.00	1.19
3 x 1/2	1.53	3.50	2.56
3 x 3/4	1.53	3.50	2.56
3 x 1	1.53	3.50	2.56
3 x 1 1/4	1.53	3.50	2.56
3 x 1 1/2	1.53	3.50	2.56
3 x 2	1.53	3.50	2.56
3 x 2 1/2	1.53	3.50	2.56
4 x 1	1.75	4.62	7.06
4 x 1 1/4	1.75	4.62	7.06
4 x 1 1/2	1.75	4.62	7.06
4 x 2	1.75	4.62	7.06
4 x 2 1/2	1.75	4.62	7.06
4 x 3	1.75	4.62	7.06

**ASTM SA-105, ANSI B16.11*