

Figure 15-SF-U
Class 150 • Bolted Cap

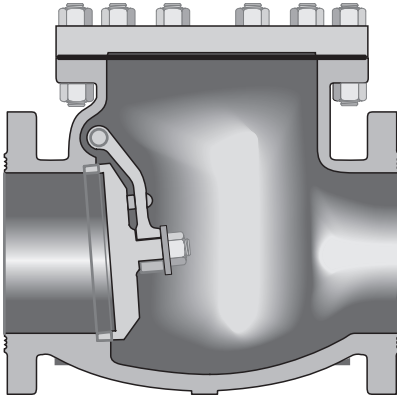

Figure 15-SF-U
Flanged

Size Range:
2 through 24 inches

Pressure Temperature Rating
Carbon Steel
ASTM A216 Grade WCB
285 psi @ -20°F to 100°F

Materials of Construction

Description	Material
Body	ASTM A216 WCB
Cap	ASTM A216 WCB
Seat Ring	ASTM A105 + AWS CoCr-A
Disc	ASTM A216 WCB + 13% Cr
Hinge	ASTM A216 WCB
Hinge Pin	ASTM A182 F6a
Disc Washer	ASTM A276 410
Cap Screw	ASTM A307 B
Cap Gasket	Soft Steel + Flexible Graphite
Cap Studs	ASTM A193 B7
Cap Nuts	ASTM A194 2H
I.D. Tags	ASTM A276 304
I.D. Pins	ASTM A276 304

Industry Standards

Steel Valves	ASME B16.34
Face-to-Face/End-to-End	ASME B16.10
Flange Dimensions	ASME B16.5
Testing	API 598

Dimensions and Weights

Valve Size	Weight (pounds)	Dimensions (inches)	
		A	B
2	35	8.0	6.8
2½	48	8.5	6.9
3	64	9.5	7.6
4	101	11.5	8.7
5	130	13.0	9.3
6	148	14.0	11.3
8	309	19.5	14.0
10	485	24.5	17.9
12	694	27.5	20.9
14	970	31.0	23.6
16	1256	32.9	24.8
18	1653	38.5	27.2
20	1829	38.5	29.1
24	2997	51.0	32.3

