

The Best Products, The Best Service...

SERVICE METAL

ONE CALL GETS IT ALL



Caps SCHEDULE 160 Inches / Pounds

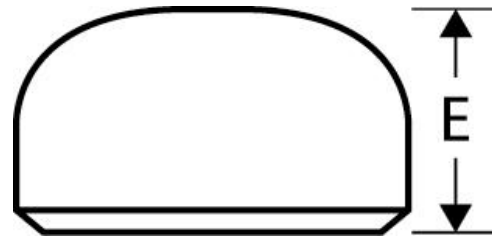

| Nominal Pipe Size | Outside Diameter | Inside Diameter | Wall Thickness | Center to End (A) | Approximate Weight (in Pounds) |
|-------------------|------------------|-----------------|----------------|-------------------|--------------------------------|
| ½ | .84 | .464 | .188 | 1.00 | – |
| ¾ | 1.05 | .612 | .219 | 1.00 | – |
| 1 | 1.32 | .815 | .250 | 1.50 | 0.4 |
| 1 ¼ | 1.66 | 1.160 | .250 | 1.50 | 0.5 |
| 1 ½ | 1.90 | 1.338 | .281 | 1.50 | 0.6 |
| 2 | 2.38 | 1.687 | .344 | 1.50 | 1.3 |
| 2 ½ | 2.88 | 2.125 | .375 | 1.50 | 1.8 |
| 3 | 3.50 | 2.624 | .438 | 2.00 | 2.9 |
| 4 | 4.50 | 3.438 | .531 | 2.50 | 5.9 |
| 5 | 5.56 | 4.313 | .625 | 3.00 | 10.0 |
| 6 | 6.63 | 5.187 | .719 | 3.50 | 15.0 |
| 8 | 8.63 | 6.813 | .906 | 4.00 | 31.0 |
| 10 | 10.75 | 8.500 | 1.125 | 5.00 | 57.0 |
| 12 | 12.75 | 10.126 | 1.312 | 6.00 | 95.0 |
| 14 | 14.00 | 11.188 | 1.406 | 6.50 | 200.0 |
| 16 | 16.00 | 12.812 | 1.594 | 7.00 | 297.0 |
| 18 | 18.00 | 14.438 | 1.781 | 8.00 | – |
| 20 | 20.00 | 16.062 | 1.969 | 9.00 | – |
| 22 | 22.00 | 17.750 | 2.125 | 10.00 | – |
| 24 | 24.00 | 19.312 | 2.344 | 10.50 | – |

* Dimensions conform to ASME B16.9 & material conforms to ASTM SA-234 Grade B.