



The Best Products, The Best Service...

SERVICE METAL

ONE CALL GETS IT ALL

Lap Joint Flange CLASS 900 Inches / Pounds

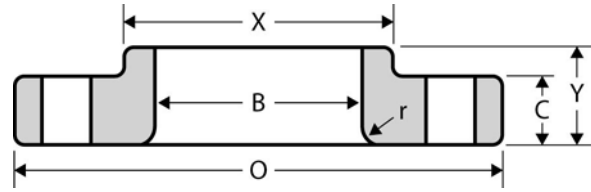

Nominal Pipe Size	Outside Diam. of Flange (O)	Thick. of Flange (C)	Diam. of Hub at Base (X)	Length thru Hub (Y)	Diam. of Bore (B)	Fillet Radius (r)	No. of Holes	Diam. of Holes	Diam. of Bolts	Diam. of Bolt Circle	Approx. Weight (in Pounds)											
1/2	USE CLASS 1500 DIMENSIONS IN THESE SIZES																					
3/4																						
1																						
1 1/4																						
1 1/2																						
2																						
2 1/2	USE CLASS 1500 DIMENSIONS IN THESE SIZES																					
3												9.50	1.50	5.00	2.12	3.60	0.38	8	1.00	0.88	7.50	25
4												11.50	1.75	6.25	2.75	4.60	0.44	8	1.25	1.12	9.25	51
5												13.75	2.00	7.50	3.12	5.69	0.44	8	1.38	1.25	11.00	81
6												15.00	2.19	9.25	3.38	6.75	0.50	12	1.25	1.12	12.50	105
8												18.50	2.50	11.75	4.50	8.75	0.50	12	1.50	1.38	15.50	190
10	21.50	2.75	14.50	5.00	10.92	0.50	16	1.50	1.38	18.50	275											
12	24.00	3.12	16.50	5.62	12.92	0.50	20	1.50	1.38	21.00	370											
14	25.25	3.38	17.75	6.12	14.18	0.50	20	1.62	1.50	22.00	415											
16	27.75	3.50	20.00	6.50	16.19	0.50	20	1.75	1.62	24.25	465											
18	31.00	4.00	22.25	7.50	18.20	0.50	20	2.00	1.88	27.00	650											
20	33.75	4.25	24.50	8.25	20.25	0.50	20	2.12	2.00	29.50	810											
24	41.00	5.50	29.50	10.50	24.25	0.50	20	2.62	2.50	35.50	1,550											

* Dimensions conform to ASTM A/SA-105; ANSI B16.5