

The Best Products, The Best Service...

SERVICE METAL

ONE CALL GETS IT ALL



Union with Brass Seat
150# Malleable Iron
Inches / Pounds

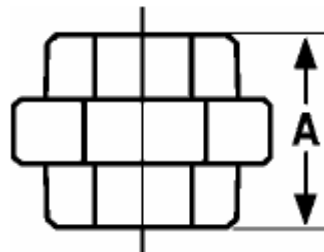

Size	A	Approximate Weight (in Pounds)
1/8	1.32	0.16
1/4	1.44	0.22
3/8	1.61	0.32
1/2	1.72	0.46
3/4	2.02	0.58
1	2.19	0.90
1 1/4	2.26	1.20
1 1/2	2.47	1.64
2	2.75	2.40
2 1/2	3.25	4.16
3	3.54	5.45
4	3.85	9.50

**Malleable Castings conform to ASTM A197*

**Hot-Dipped Galvanized Fittings conform to ASTM A153*

**Malleable Fitting Dimensions conform to ASME B16.3*

**Malleable Bushings, Plugs and Locknuts conform to ASME B16.14*

**Malleable Unions conform to ASME B16.39*

**NPT Threads on all fittings conform to ASME B1.20.1*

**Class 150 fittings are UL listed and FM approved at 300 psi*

**Class 300 fittings are UL listed*