

The Best Products, The Best Service...

SERVICE METAL

ONE CALL GETS IT ALL



Blind Flange CLASS 150 Inches / Pounds

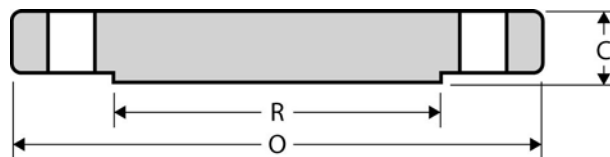

Nominal Pipe Size	Outside Diam. of Flange (O)	Thick. of Flange (C)	Diam. of Raised Face (R)	No. of Holes	Diam. of Holes	Diam. of Bolts	Diam. of Bolt Circle	Approx. Weight (in Pounds)
½	3.50	0.44	1.38	4	0.62	0.50	2.38	1
¾	3.88	0.50	1.69	4	0.62	0.50	2.75	2
1	4.25	0.56	2.00	4	0.62	0.50	3.12	2
1 ¼	4.62	0.62	2.50	4	0.62	0.50	3.50	3
1 ½	5.00	0.69	2.88	4	0.62	0.50	3.88	4
2	6.00	0.75	3.62	4	0.75	0.62	4.75	5
2 ½	7.00	0.88	4.12	4	0.75	0.62	5.50	7
3	7.50	0.94	5.00	4	0.75	0.62	6.00	9
3 ½	8.50	0.94	5.50	8	0.75	0.62	7.00	13
4	9.00	0.94	6.19	8	0.75	0.62	7.50	17
5	10.00	0.94	7.31	8	0.88	0.75	8.50	20
6	11.00	1.00	8.50	8	0.88	0.75	9.50	26
8	13.50	1.12	10.62	8	0.88	0.75	11.75	45
10	16.00	1.19	12.75	12	1.00	0.88	14.25	70
12	19.00	1.25	15.00	12	1.00	0.88	17.00	110
14	21.00	1.38	16.25	12	1.12	1.00	18.75	140
16	23.50	1.44	18.50	16	1.12	1.00	21.25	180
18	25.00	1.56	21.00	16	1.25	1.12	22.75	220
20	27.50	1.69	23.00	20	1.25	1.12	25.00	285
24	32.00	1.88	27.25	20	1.38	1.25	29.50	430

* Dimensions conform to ASTM A/SA-105; ANSI B16.5